

# Material Bestellplan Plan de commande de la matière Piano del materiale

Pos. 1.1  
BLE 8 "Laserteil" / Tôle 8 " pièce Laser " / BLE 8 "pezzi al laser"  
1 Stk. / 1 pce / 1 pezzo

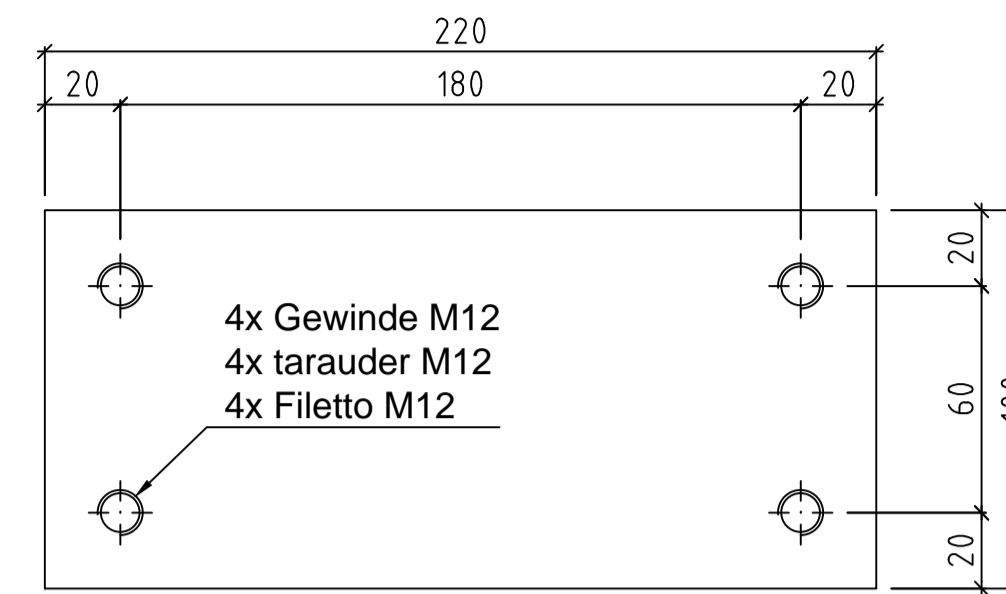
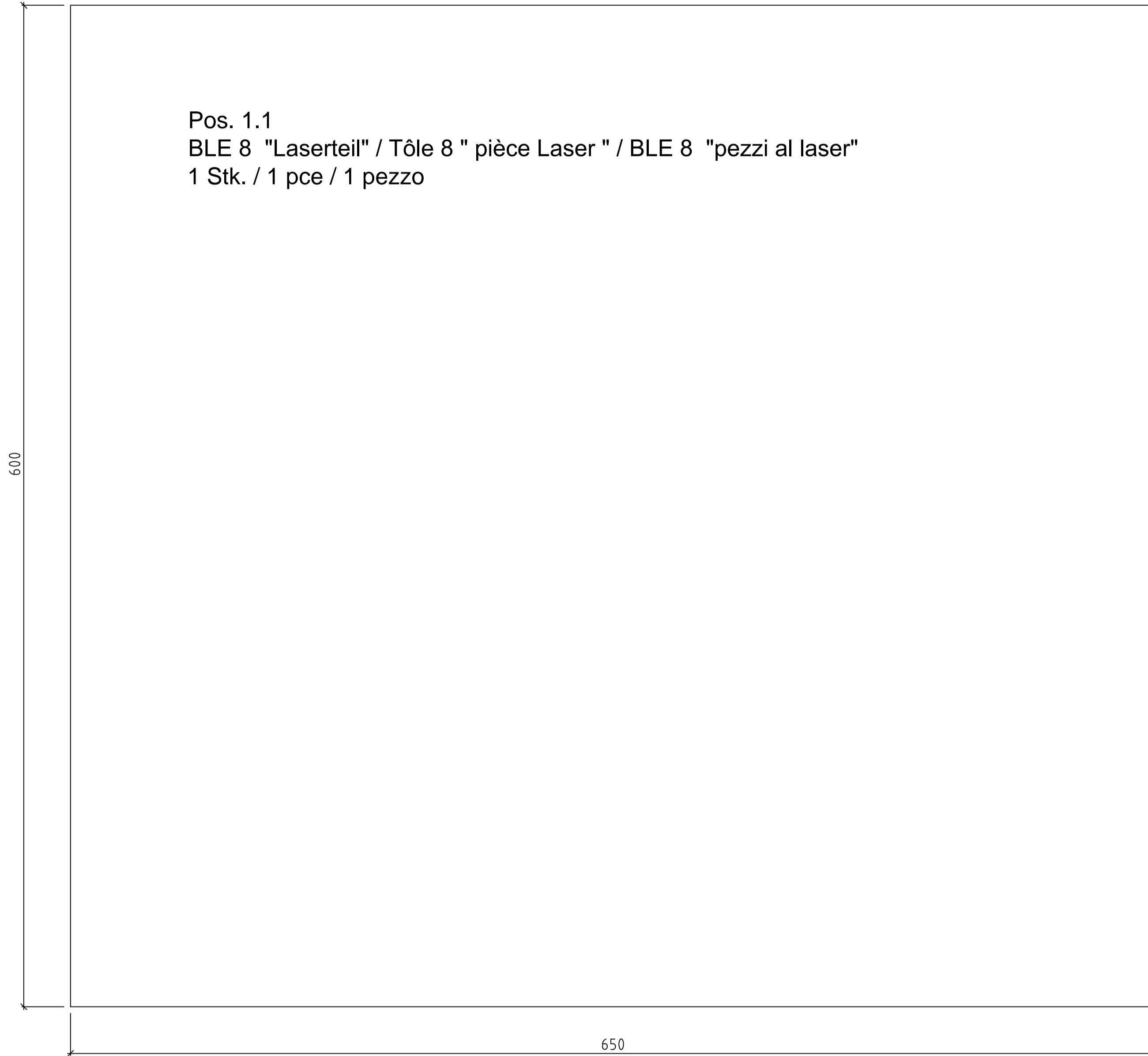

Pos. 4.3  
FLA 100x12-220  
2 Stk. / 2 pces / 2 pezzi

Pos. 4.4  
FLA 90x8-130  
4 Stk. / 4 pces / 4 pezzi

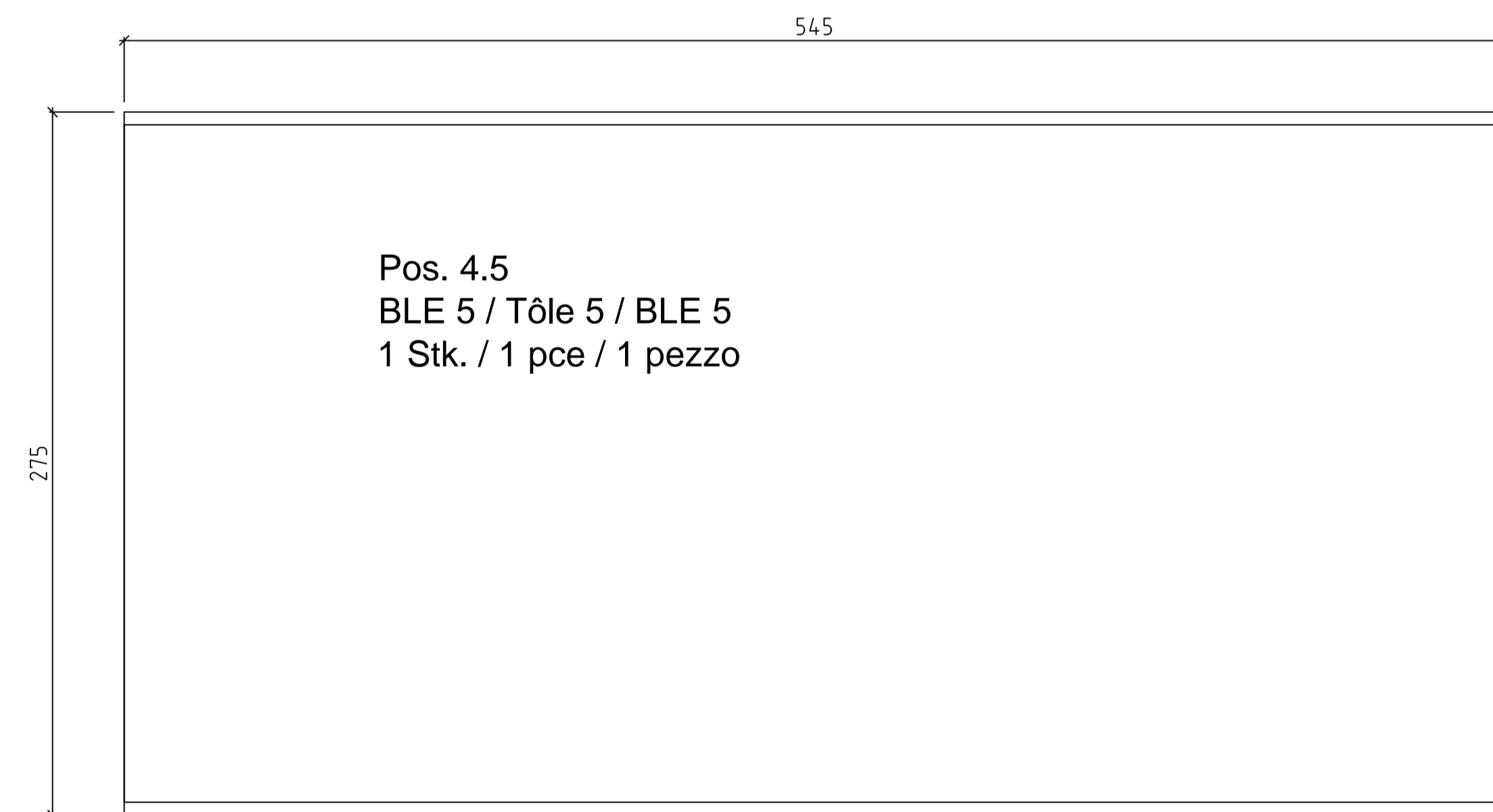
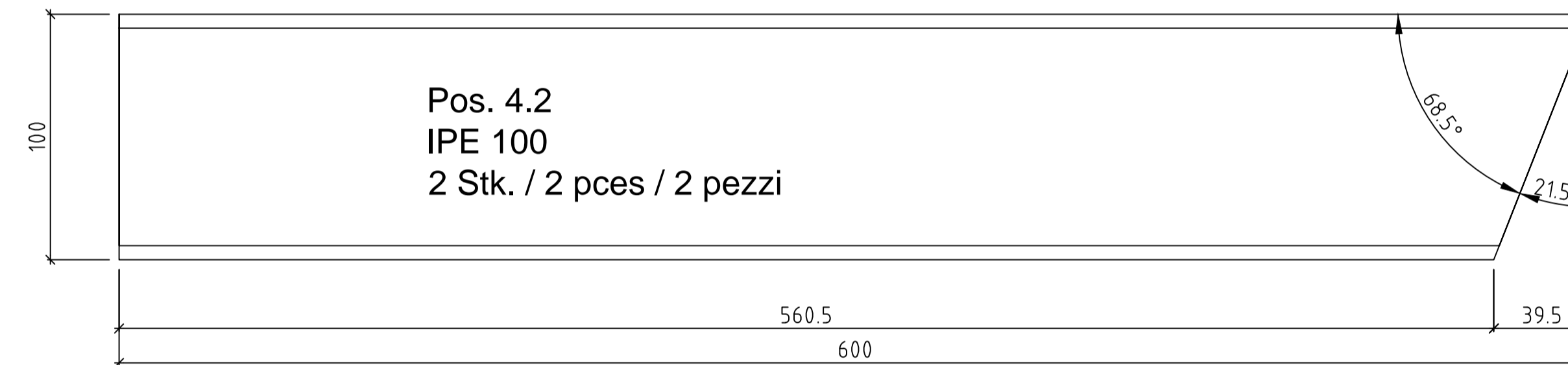
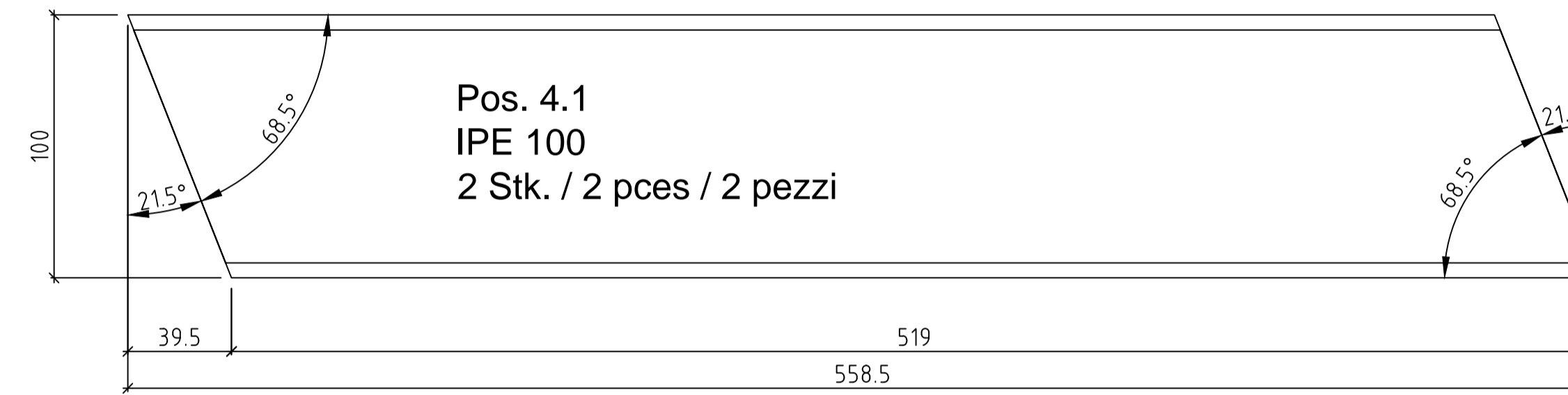
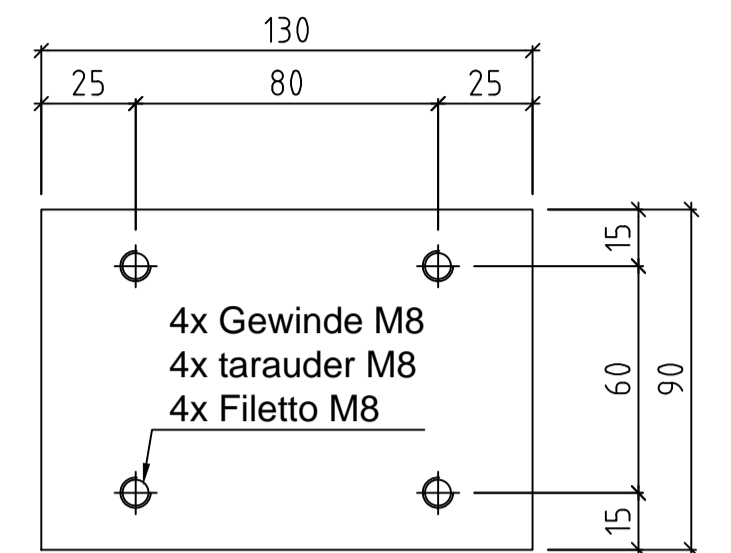

Pos. 4.6  
BLE 5 / Tôle 5 / BLE 5  
2 Stk. / 2 pces / 2 pezzi

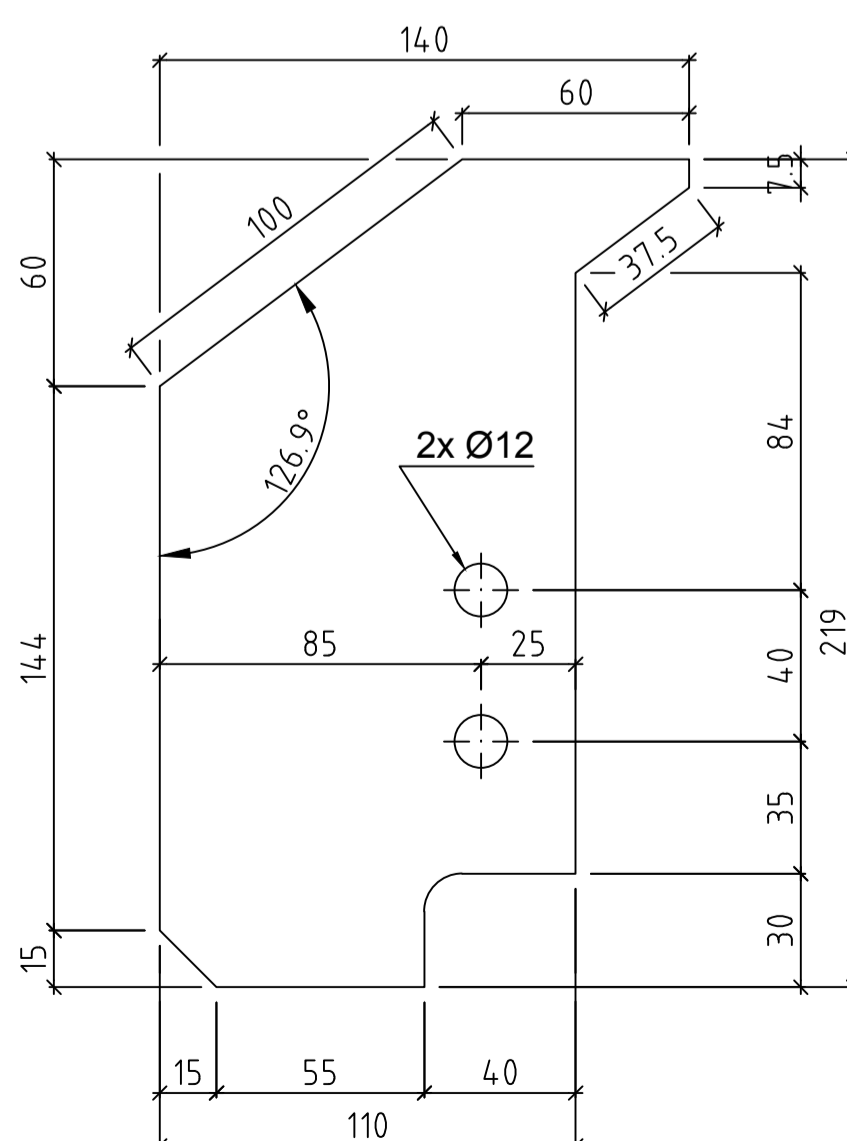
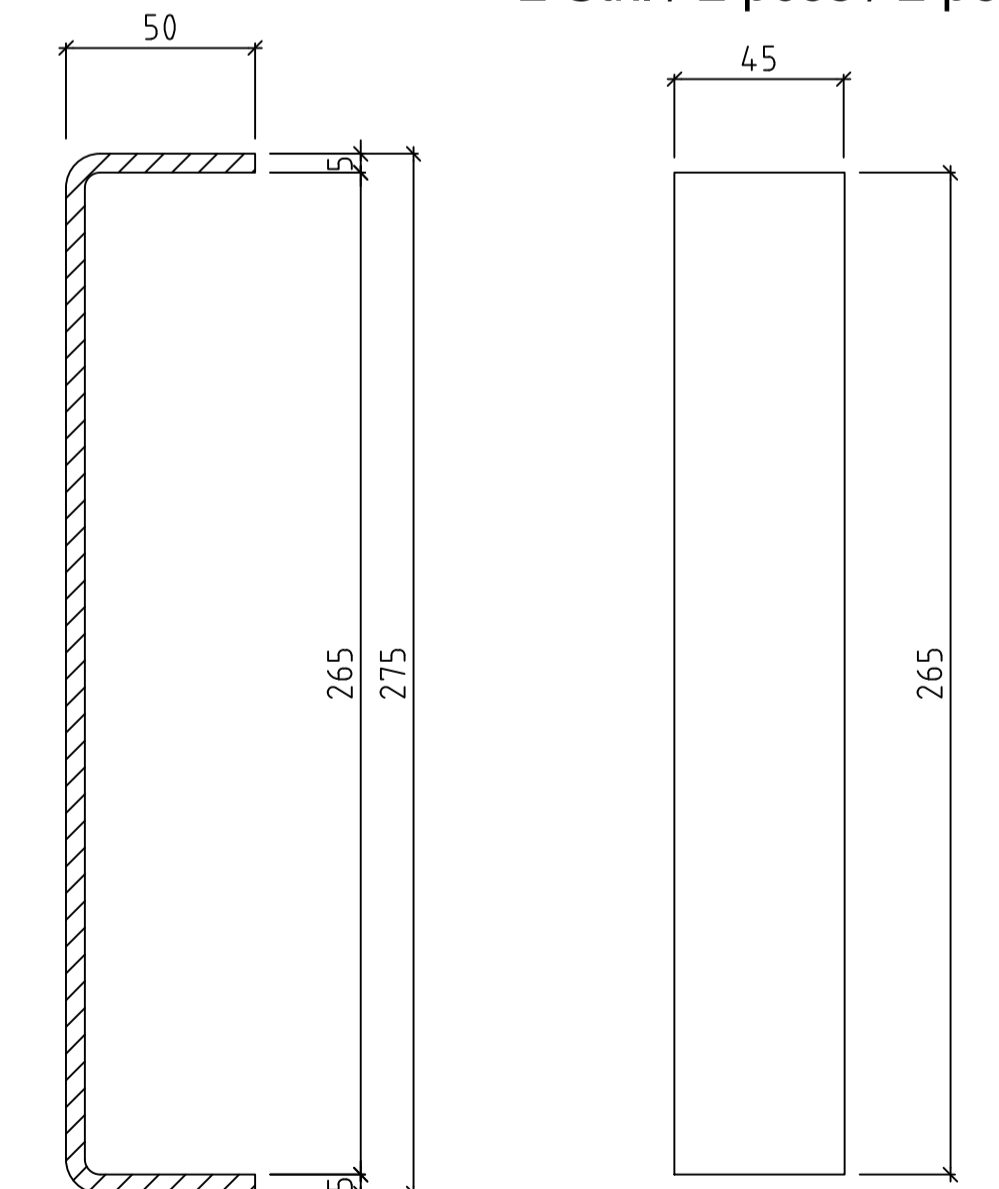

Pos. 1.3  
BLE 8 "Laserteil"  
Tôle 8 " pièces Laser "  
BLE 8 "pezzo al laser"  
4 Stk. / 4 pces / 4 pezzi

Pos. 1.4  
FLA 100x12-220  
2 Stk. / 2 pces / 2 pezzi

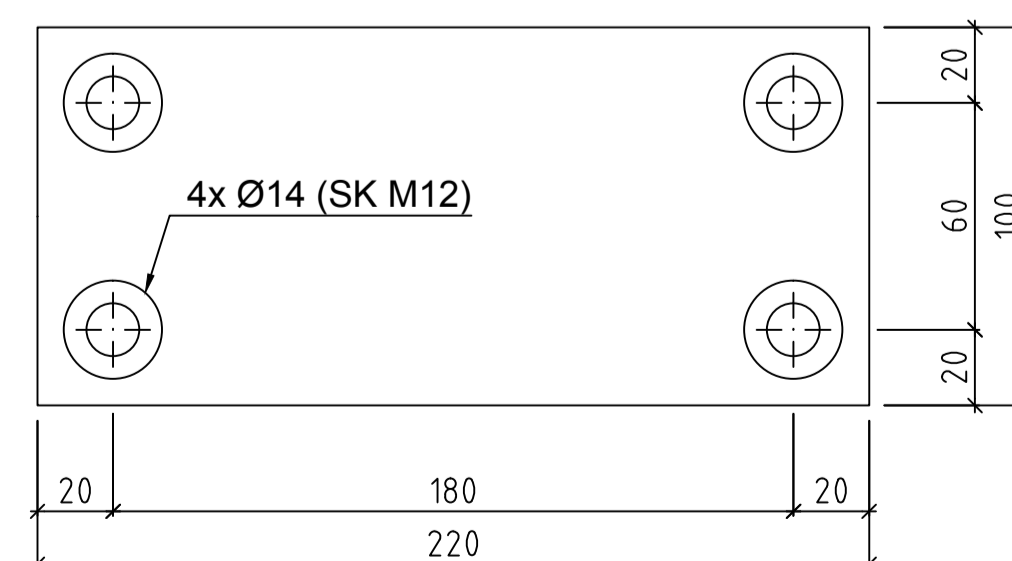

Stückzahl: pro Kandidat  
Nombre de pièces: par candidat  
Numero di pezzi: per candidato

Lehrberuf:	Übungsaufgabe QV METALLBAUER	Zeichn.No.	23
Profession:	Esercizio EFA CONSTRUCTEUR METALLIQUE	Dessin.No.	
Professione:	Esercizio PQ METALCOSTRUTTORI	Dis. No	
Fach:	Praktische Arbeit Fachrichtung Stahlbau	Mst. / Scala:	1:2
Branche:	Travaux spécifiques, orientation charpente métallique	Gez. / Datum	
Materia:	Lavoro pratico costruzione in acciaio	Dess. / Date	Kl. 15.12.2011
Aufgabe:	Schweisstisch Material-Auszug	Gepr. / Datum	
Devoir:	Table de soudure, commande de la matière	Contr. / Date	
Compito:	Tavolo di saldatura Materiale - bacinella	Geän. / Datum	Kl. 13.03.2012
Metallbau Schweizerische Metall-Union Construction métallique Union Suisse du Métal Metalcostruzioni Unione Svizzera del Metallo			
ÜQV 2014			